



ELECTRIC DEVICES FOR ELECTRIC OR PETROL ENGINES MANAGEMENT AND ORDER FORM MODEL SM 180EL

Characteristics:

Device to start the engine with disconnected removable key (see note): open contact; connected and pressed key: closed contact

Assembly: on walls or on tubes

Fastening type:

on walls, with flat holder and two fastening screws

on tubes, with high holder (10,5 mm) and through screw: protrusion 29 mm (for tubes up to D.22) or 34 mm (for tubes up to D.28)

on tubes, with short holder (5 mm) and through screw: protrusion 29 mm (for tubes up to D.22) or 34 mm (for tubes up to D.28)

on tubes, with holder and nylon collar: for tube outer diameter: 22 mm - 25 mm - 26 mm - 27 mm - 28 mm

Material: nylon Key colour: red Holder colour: black

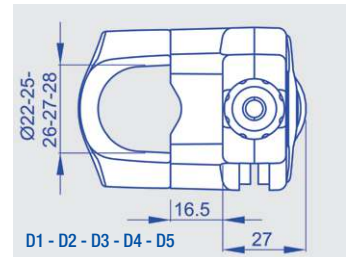
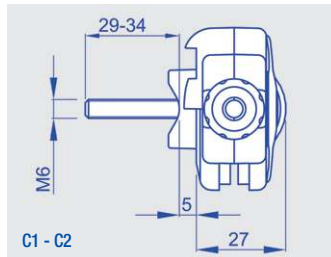
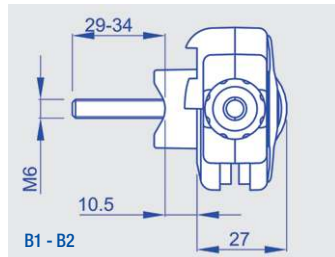
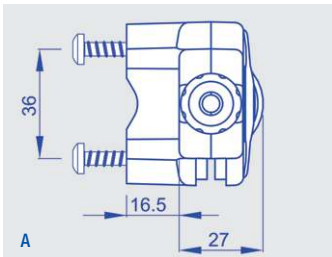
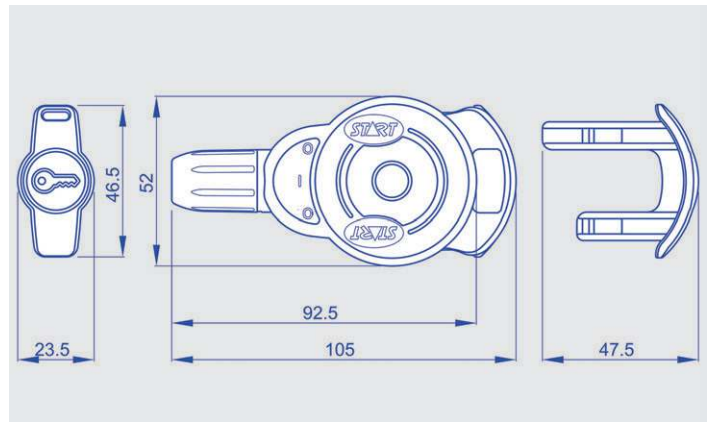

To order: compose, please, your product code inserting the boldfaced code corresponding to the chosen option in the proper square.

SM 180EL

- Fastening on walls: **A**
- Fastening on tubes with screw protrusion 29 mm and high holder: **B1**
- Fastening on tubes with screw protrusion 34 mm and high holder: **B2**
- Fastening on tubes with screw protrusion 29 mm and short holder: **C1**
- Fastening on tubes with screw protrusion 34 mm and short holder: **C2**
- Fastening on tubes with collar Ø 22 mm: **D1**
- Fastening on tubes with collar Ø 25 mm: **D2**
- Fastening on tubes with collar Ø 26 mm: **D3**
- Fastening on tubes with collar Ø 27 mm: **D4**
- Fastening on tubes with collar Ø 28 mm: **D5**



ELECTRIC DEVICES COMPATIBLE ELECTRIC CABLES MODELS SM 100EL - SM 180EL

Characteristics:

- Cable outer diameter: Ø5,5 mm
- Cable length: upon request
- Wires diameter: Ø2x0,75 mm
- Wires stripping length: upon request
- Wires terminals: see table

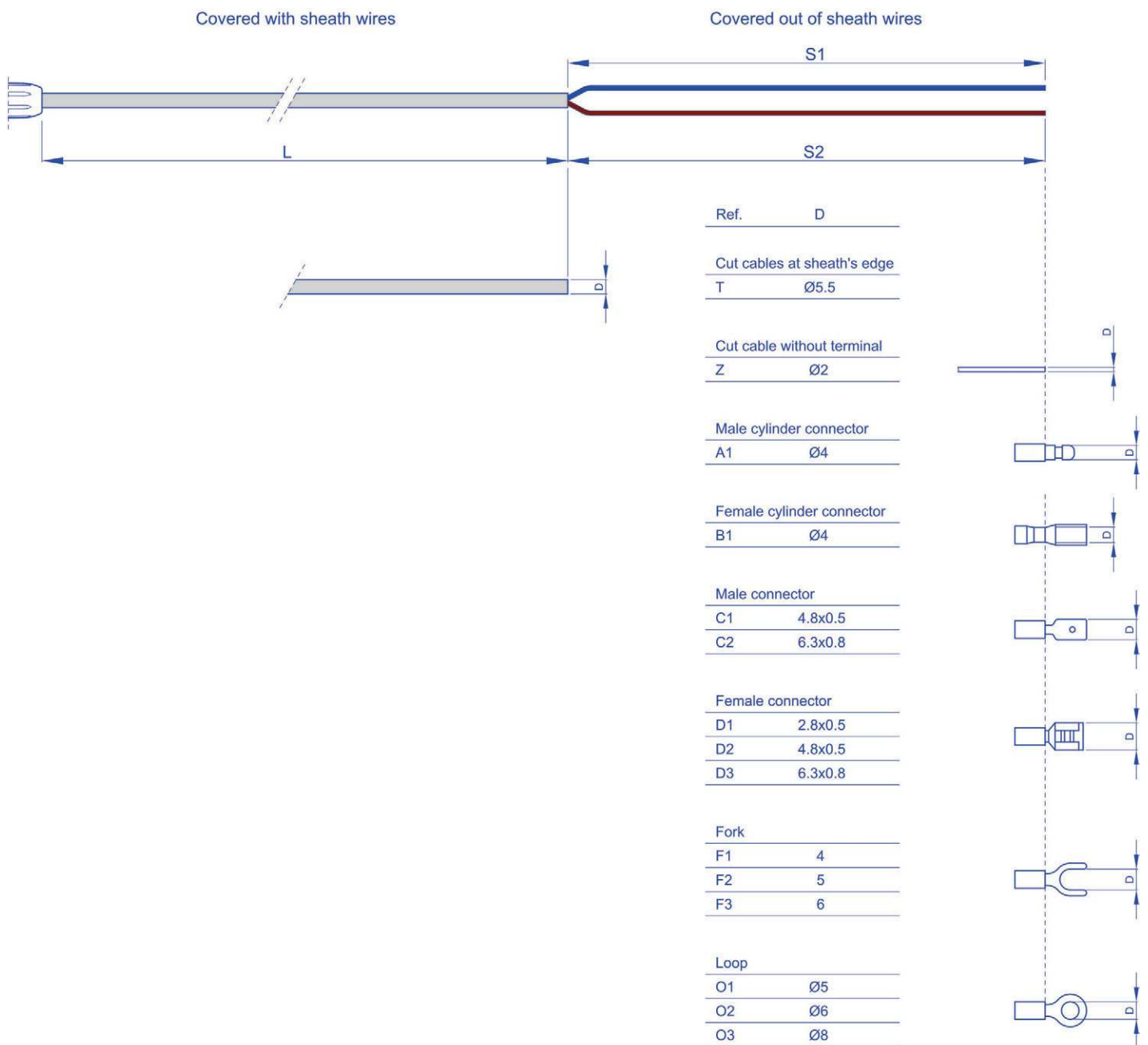



ELECTRIC DEVICES ORDER FORM FOR COMPATIBLE ELECTRIC CABLES MODELS SM 100EL - SM180EL

To order:

The technical options that are represented on the opposite page are the standard personalizations which are provided from the company.

Among these possibilities, you can choose the cable construction that meets your requirements.

At first choose if you want the covered wires cut at sheath's edge or the covered out of sheath wires and eventually select the corresponding terminals among the possible options.

Find out your preferences and fill in the boxes with the number or the letters/number corresponding to your options.

Example: if you choose the covered out of sheath wires and you want a loop on the blue wire as terminal, indicate the code 12 or 13 or 14, according to your needs.

And so on for other variables.

The same procedure must be used for the brown wire and then select the corresponding options.

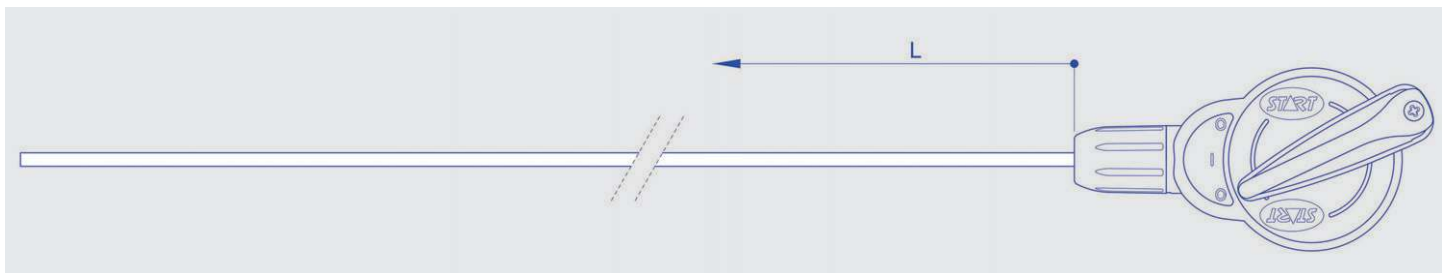

To order: compose, please, your product code inserting the boldfaced code corresponding to the chosen option in the proper square.

<input type="checkbox"/> Cut cables at sheath's edge (T)		<input type="checkbox"/> Blue covered cable <input type="checkbox"/> Brown covered cable					
Covered with sheath cables length (L) in mm: _____							Brown out of sheath wire length (S2) in mm: _____
Covered out of sheath wire Z: 01 _____							Covered out of sheath wire Z: 15 _____
Male cylinder connector A1: 02 _____							Male cylinder connector A1: 16 _____
Female cylinder connector B1: 03 _____							Female cylinder connector B1: 17 _____
Male connector C1: 04 _____							Male connector C1: 18 _____
Male connector C2: 05 _____							Male connector C2: 19 _____
Female connector D1: 06 _____							Female connector D1: 20 _____
Female connector D2: 07 _____							Female connector D2: 21 _____
Female connector D3: 08 _____							Female connector D3: 22 _____
Fork F1: 09 _____							Fork F1: 23 _____
Fork F2: 10 _____							Fork F2: 24 _____
Fork F3: 11 _____							Fork F3: 25 _____
Loop O1: 12 _____							Loop O1: 26 _____
Loop O2: 13 _____							Loop O2: 27 _____
Loop O3: 14 _____							Loop O3: 28 _____
Blue out of sheath wire length (S1) in mm: _____							